

**vario**  **vent**  
VENTILATION SYSTEMS

DECENTRALIZED VENTILATION UNIT  
**VARIO-VENT DUO**



## DECENTRALIZED VENTILATION UNIT VARIO-VENT DUO: THIS IS WHAT YOU CAN EXPECT OF US

The Vario-Vent DUO ventilation unit is very compact and provides a direct air supply and return of single rooms – heat recovery included. Vario-Vent DUO protects your home or building in impressive ways, saves energy and your wallet. The discreet design integrates harmoniously into all rooms. No matter if you have a new build or an existing building; Vario-Vent DUO is the optimal solution for a fresh air supply for single rooms or complete residential apartment or home with an installation of several units.



## SAFETY/BURGLARY PROTECTION

Being able to enjoy fresh air without having to open a window naturally reduces the danger of unwanted guests in your home.



## ENERGY EFFICIENCY

Vario-Vent DUO reduces energy losses compared to window ventilation. Our unit is operated with a 12 volt Green Tech fan that consumes maximal 11 watt. Construction costs may possible be reduced with the corresponding funds.



## MOISTURE PROTECTION/PRESERVATION

Moist air is transported reliably to the outside. Mold and other negative impacts do not stand a chance.



## CONVENIENT OPERATION

The intuitive Vario-Vent DUO control panel allows navigating and selecting various settings desired to your needs in a very fast manner.



Installation suggestion:  
The calculation of the air volume for the humidity protection is in accordance with DIN 1946-6. This proposal does not replace any engineering service.

Make sure to plan in sufficient space between doors and the flooring to allow for interconnected airways.

<sup>1)</sup> Moist-, time- / or light controlled bathroom fans and ventilators should be installed on-site.

<sup>2)</sup> Hint:  
Please install a kitchen exhaust system on-site!

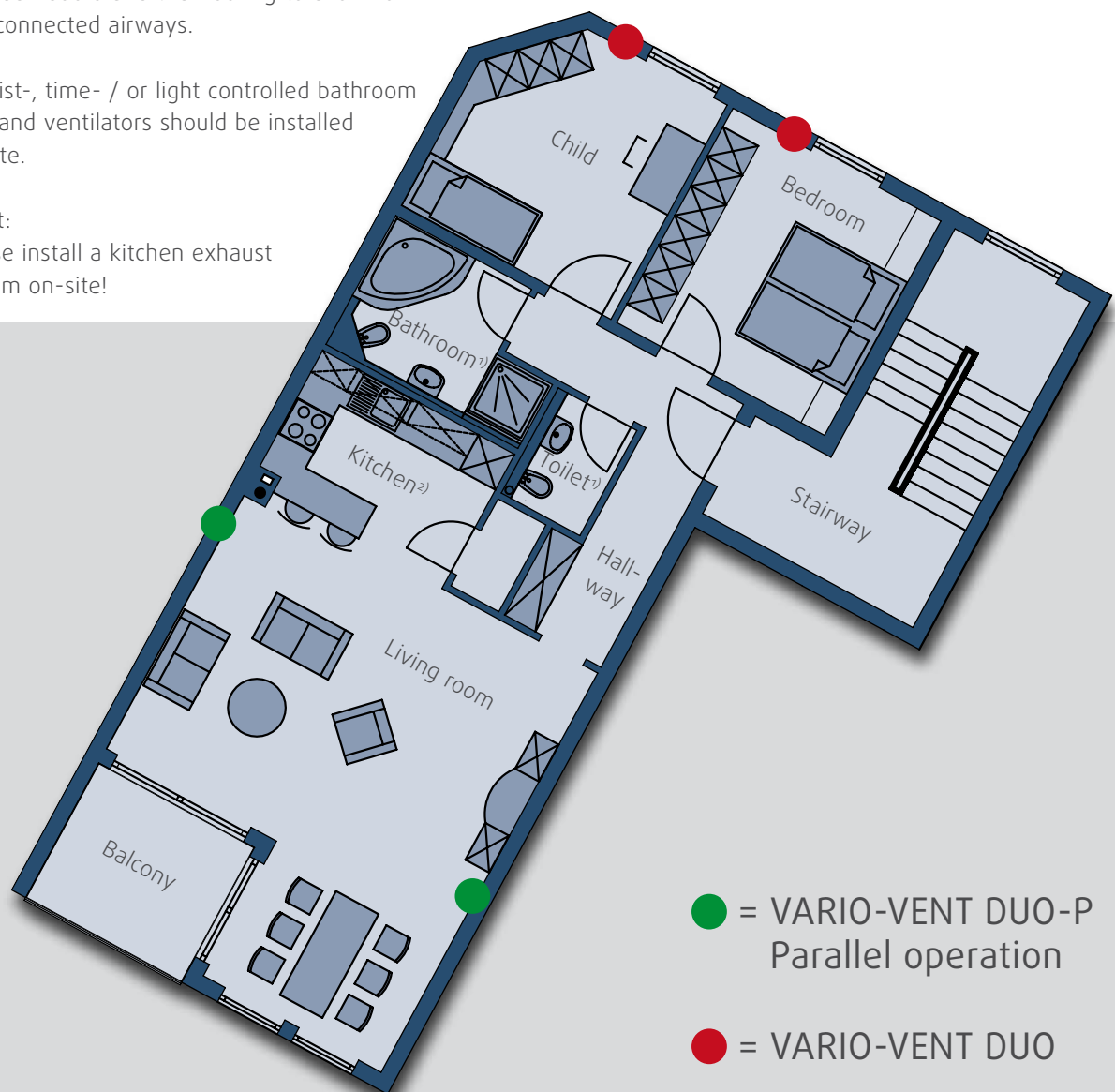

# SIMPLE IN-WALL INSTALLATION

## INSTALLATION DETAILS

All you need to install the Vario-Vent DUO is a core drilled hole and an on-site electrical power supply. The Vario-Vent DUO is then inserted into the casting tube and connected.

The possibility of being able to shorten the Vario-Vent DUO individually makes it a perfect solution for all walls from 270 to 560 mm.

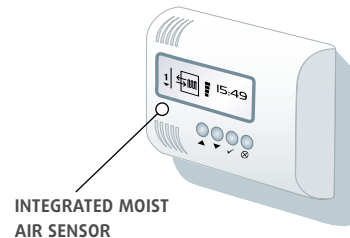
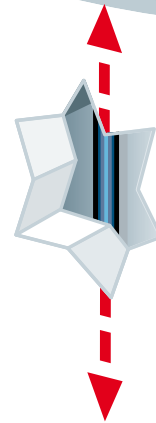
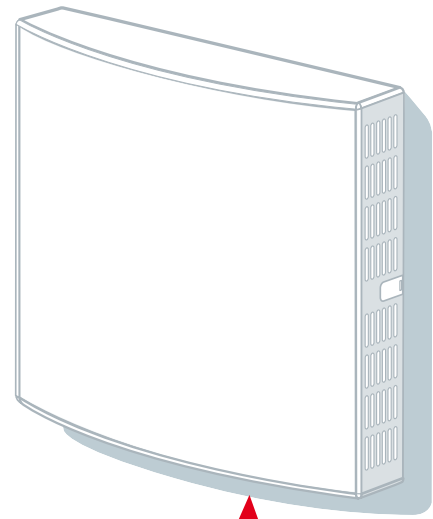
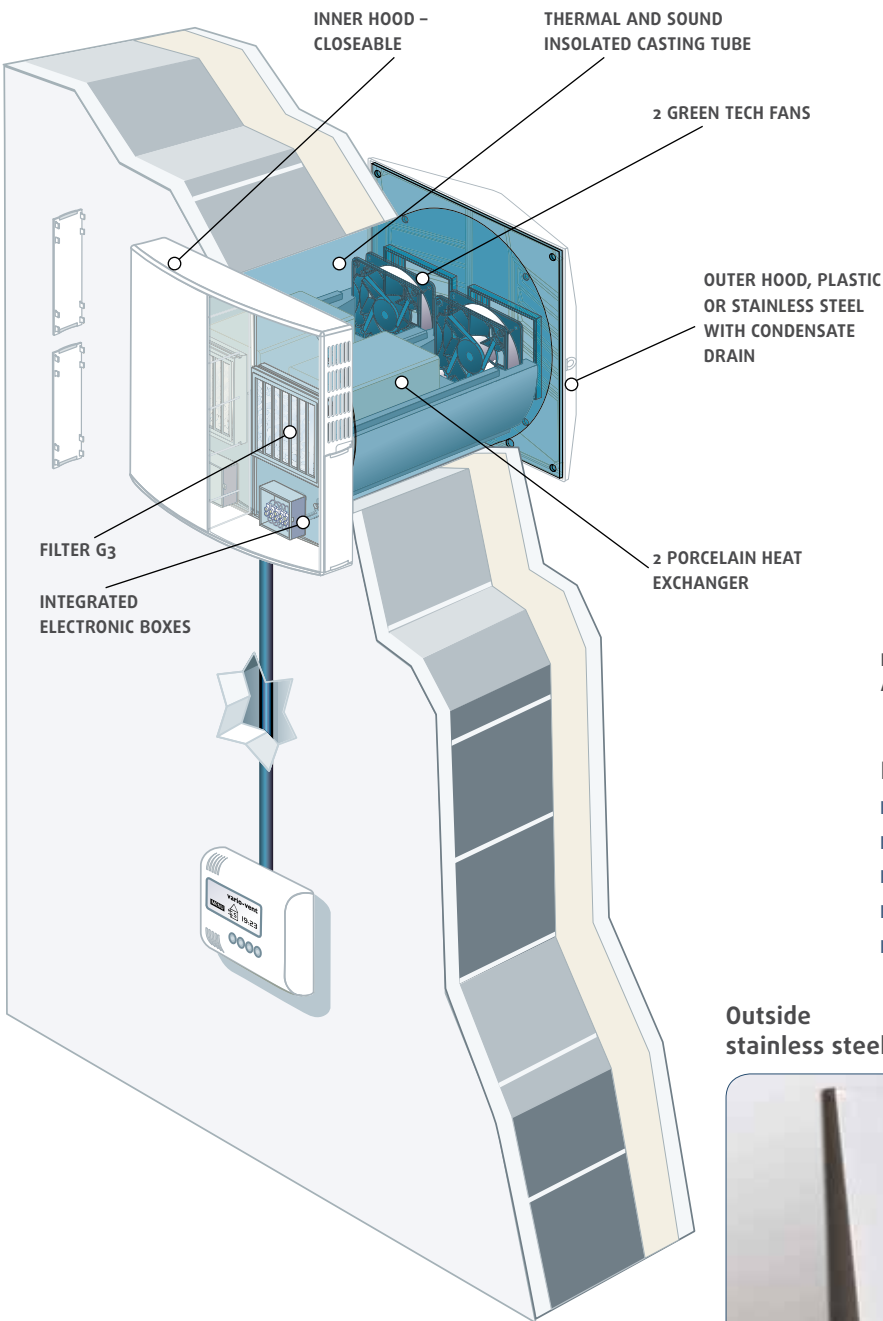

### EASY INSTALLATION

- Integrated plaster guard and level
- Minimum wall thickness: 270 mm
- Maximum wall thickness: 560 mm
- Extension tube for wall thickness over 560 mm
- Integrated electronic boxes for wiring

Outside stainless steel



Outside plastic



## HIGHLIGHTS:

### MATERIAL

- Thermal and sound insulated casting tube material EPP
- Light and heat resistant material PP
- Porcelain heat exchanger
- Food-quality material

### OPERATION

- Filter G3
- 9 operating modes
- Tool-less filter change
- Control panel included
- Integrated moist air sensor

### ECONOMIC

- Thermal efficiency max 91 %
- Airborne sound insulation up to 45 dB
- Consumes maximal 11 watt eco
- Whisper quiet operation
- 1 unit for supply and extract air at the same time

### VARIABILITY

- Potential connection for smoke detector or depression sensor
- Porcelain heat exchanger
  - closed surface structure
  - Bacterial free
  - Hygienic
  - Dishwasher safe
  - 2 x 0,68 m<sup>2</sup> surface area
- Low-key appearance with minimal space required
- Filters and heat exchangers are very simple to clean



GOOD AIR ENSURES FOR A CLEAR HEAD

### OPTIONAL SERVICE SOFTWARE

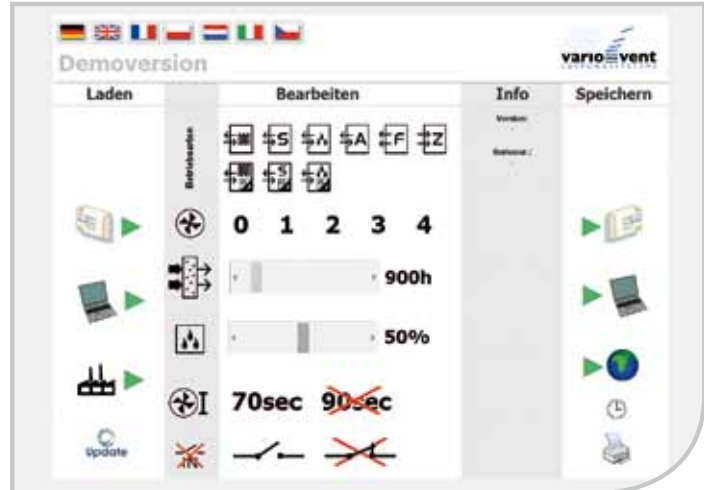

### OPTIONAL SERVICE

- Pattern of use is documentable and presentable with the USB port



## ... HANDHELD

### ALMOST AS EASY AS OPENING A WINDOW

The included Vario-Vent DUO control panel offers various possibilities such as adjusting the climate conditions to your personal needs. Fan stages are also variable beside the nine operating modes. The control panel even lets you know when it is time to clean the filter.

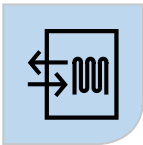

#### ■ Normal operation with heat recovery

The fans are running on the set stage in opposite directions and change directions every 70 seconds. This time may change according to the preset that has been chosen with the software.



#### ■ Ventilation while absent

The fans are running on the set stage in opposite directions just like in the "normal operation". The fans run at an interval for 15 minutes every 2 hours.



#### ■ Normal operation with heat recovery and day/night regulation

The fans are running on the set stage in opposite directions and change directions every 70 seconds. This time may change according to the preset that has been chosen with the software. The fans are on stage 1 between 7 pm and 7 am.



#### ■ Exhaust air operation

Both fans are running on the set stage blowing the air toward the outside.

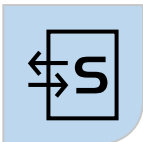

#### ■ Summer operation without heat recovery

The fans are running on the set stage in opposite directions without direction changes.

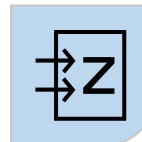

#### ■ Incoming air operation

Both fans are running on the set stage blowing the air toward the inside.



#### ■ Summer operation without heat recovery and day/night regulation

The fans are running on the set stage in opposite directions without direction changes. The fans are on stage 1 between 7 pm and 7 am.



#### ■ Fan stages:

12 (night operation), 15, 20 and 30 m<sup>3</sup>/h for supply and extract air



#### ■ Moisture protection ventilation

If the humidity rises above the set value, for exp. 55 %, the fans will run in opposite directions at the set fan stage. When the humidity drops below that value the fan will then shut off. The values can be set with the service software by a skilled tradesman.

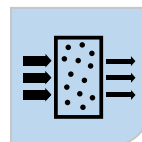

#### ■ Filter change



#### ■ Moisture protection ventilation and day/night regulation

Same function as the "moisture protection ventilation". The fans are also on stage 1 between 7 pm and 7 am. The values can be set with the service software by a skilled tradesman.



## TECHNICAL DATA | VARIO-VENT DUO

MODEL	VARIO-VENT DUO with plastic outer hood	VARIO-VENT DUO with stainless steel outer hood				
Order number	651000	651003				
Mains voltage	Extern 230 Volt, Intern 12 Volt					
<b>FAN DATA:</b>						
Number of fans	2 x					
Temperature range	-20 to +75°					
Max. electricity consumption	11 Watt					
Max. air volume flow (in m³/h)	10	20	30	40	50	60
	1	2	3	4		
Supply and extract air (4 stages)						
Extract air only (4 stages)						
Supply air only (4 stages)						
<b>HEAT EXCHANGER:</b>						
Porcelain heat exchanger	2 x					
Surface area	2 x 0,86 m²					
Max. efficiency up to	91 %					
Max. regulation noise-level difference	D <sub>NW</sub> 45 dB R <sub>w 1,9</sub> 28 dB					
Sound pressure	19-45 dB(A)					
<b>MEASUREMENTS:</b>						
Length	270-560 mm					
Circumference	290 mm					
Front cover measurements	300 x 300 mm					
<b>OPTIONAL CONNECTION POSSIBILITIES:</b>						
Potential-free switching input	yes					
Interface	USB					
<b>DELIVERY CONTENTS:</b>						
	1 x Vario-Vent DUO, 1 x Inner hood, 1 x Casing tube, 1 x control panel, screws and dowels, 2 x Filter G3, 1 x Plaster guard with level 1 x Plastic outer hood 1 x Operating and installation instructions manual	1 x Vario-Vent DUO, 1 x Inner hood, 1 x Casing tube, 1 x control panel, screws and dowels, 2 x Filter G3, 1 x Plaster guard with level 1 x Stainless steel outer hood 1 x Operating and installation instructions manual				

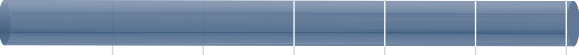
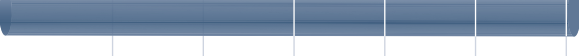

## TECHNICAL DATA | VARIO-VENT DUO-P

MODEL	Parallel operation package Vario Vent DUO-P with stainless steel outer hood
Order number	651010: 2 x Vario-Vent DUO-P and 1 x control panel
Mains voltage	external 2 x 230 volt, internal
<b>FAN DATA:</b>	
Number of fans	2 x 2
Temperature range	-20 to +75°
Max. electricity consumption	2 x 11 Watt
Max. air volume flow (in m³/h)	
	20    40    60    80    100    120
Supply and extract air (4 stages)	
Extract air only (4 stages)	
Supply air only (4 stages)	
<b>HEAT EXCHANGER:</b>	
Porcelain heat exchanger	2 x 2
Surface area	4 x 0,86 m²
Max. efficiency up to	91 %
Max. regulation noise-level difference	D <sub>NW</sub> 45 dB, R <sub>w 1,9</sub> 28 dB
Sound pressure	19-45 dB(A)
<b>MEASUREMENTS:</b>	
Length	270-560 mm
Circumference	2 x 290 mm
Front cover measurements	2 x 300 x 300 mm
<b>OPTIONAL CONNECTION POSSIBILITIES:</b>	
Potential-free switching input	yes
Interface	USB
<b>DELIVERY CONTENTS:</b>	
	2 x Vario-Vent DUO-P, 2 x Inner hood, 2 x Casing tube, 1 x control panel, screws and dowels, 4 x Filter G3, 2 x Plaster guard with level, 2 x Plastic outer hood, 1 x Operating and installation instructions manual



Name of supplier: